

yala

**Engineering and
Facilities
Management
Salary Survey**

2021

Engineering and Facilities Management | Overview

The Covid-19 pandemic has forced many companies worldwide in the facility-management services market to halt their business operations to comply with new government regulations to contain the spread of the virus. In 2020 a lot of employees were laid off or had to work from home, FM teams may have been cut back to skeleton crew on some sites. Commercial building where the worst affected, along with office buildings, schools, retail complex's and hotels.

With strict restrictions in place, the pandemic has seen the rise of automation in facility management processes such as move-ins, energy management, service requests, and workspace customisation. Technological advancements and investments in the infrastructure create new opportunities in the coming years.

User experience will be key in the workplace on the return to the workplace. As we come in 2021 there will be a push for office and workplaces to be made socially distanced. This will be a new chapter in the workplace environment. The management of the facilities will be critical to provide a socially distanced and safe environment for workers to return to work. They will be creating workplaces for the future. There will be a need for more awareness of space, cleanliness, temperature and humidity in a room to keep the chances of spreading the virus to a minimum. There will be a need again for Facilities Teams on site as the lockdown restriction are lifted. As we move forward Teams will need to identify how to re shape the organisation to fit this new world.

Yala's 2021 Engineering and Facilities Management Salary Guide provides insight into salaries for candidates looking for a new position or companies looking for new talent. Here you will find reliable salary figures for Dublin and other regions based on the knowledge and information gathered by our team of experts in the field. We decided to keep it short and sweet, so you don't waste your time going through some unnecessary information. If you would like more in depth or detailed advice, please do not hesitate to contact us for a free consultation!



*€ Euro

Soft Services

	Dublin	Regional
Moving and Change Coordinator	45k-55k	40k-50k
Moving and Change Operative	35k-42k	30k-40k
Facilities Administrator	40k-50k	35k-45k
Mail Room Operative	20k-30k	18k-25k

Hard Services

	Dublin	Regional
Building Services Engineer	55k-65k	52k-55k
Facilities Engineer	60K-80k	52k-60k
Maintenance Engineer	45k-55k	40k-50k
Serives Engineer	40k-50k	35k-45k
Facilities Coordinator	40k-55k	35k-45k
Electrical Technician	52k-58k	50k-55k
Facilities Technician	45k-52k	40k-50k
Facilities Operative	35k-42k	30k-40k

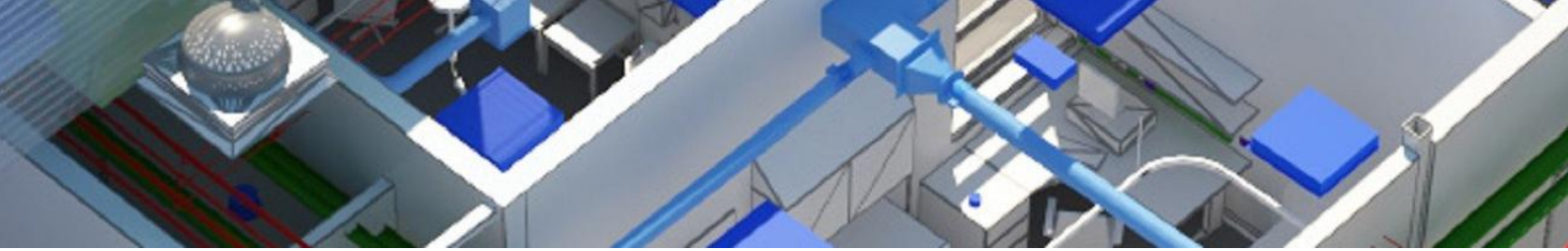

Engineering and Facilities Management

	Dublin	Regional
Director of Facilities	90k-100	90k+
Director of Engineering	90k-100	90k+
Building Services Manager	65k-70k	60k-65k
Engineering Manager	80k-90k	75k-80k
Site Manager	75k-90k	65k-75k
Facilities Manager	70k-85k	60k-75K
Technical Manager	65k-70k	60k-65k
Workplace Manager	55k-60k	50k-55k
Maintenace Manager	65k-80k	55k-65k
Servies Manager	65k-80k	45k-55k
Multi- Site Account Manager	60k-65	50k -55k
Account Manager	50k-60k	45k-55k

Contact us

Address: Unit 3
Finches Industrial Estate,
Dublin 12,
D12 P62N
Phone: (01) 693 3357
Website: www.yala.ie



Yala Connect

